

770*
sq.ft.PHONE: (909) 602 2022 | thecrossings@circamgt.com
26000 West Lugonia Avenue, Redlands, CA 92374

KEY FEATURES

- Samsung Stainless Steel Appliances
- Double Door Refrigerator with Ice Maker
- Samsung Front Loader Washer & Dryer
- Quartz Counter Tops
- Gas Cooktop
- Wood Inspired Flooring¹
- Carpeted Bedroom²
- Private Covered Balcony³

- | | | |
|-----------------|------------|-------------------|
| 1 Entrance | 4 Bedroom | 7 Covered Balcony |
| 2 Kitchen | 5 Bathroom | 8 Washer/Dryer |
| 3 Dining/Living | 6 Closet | |

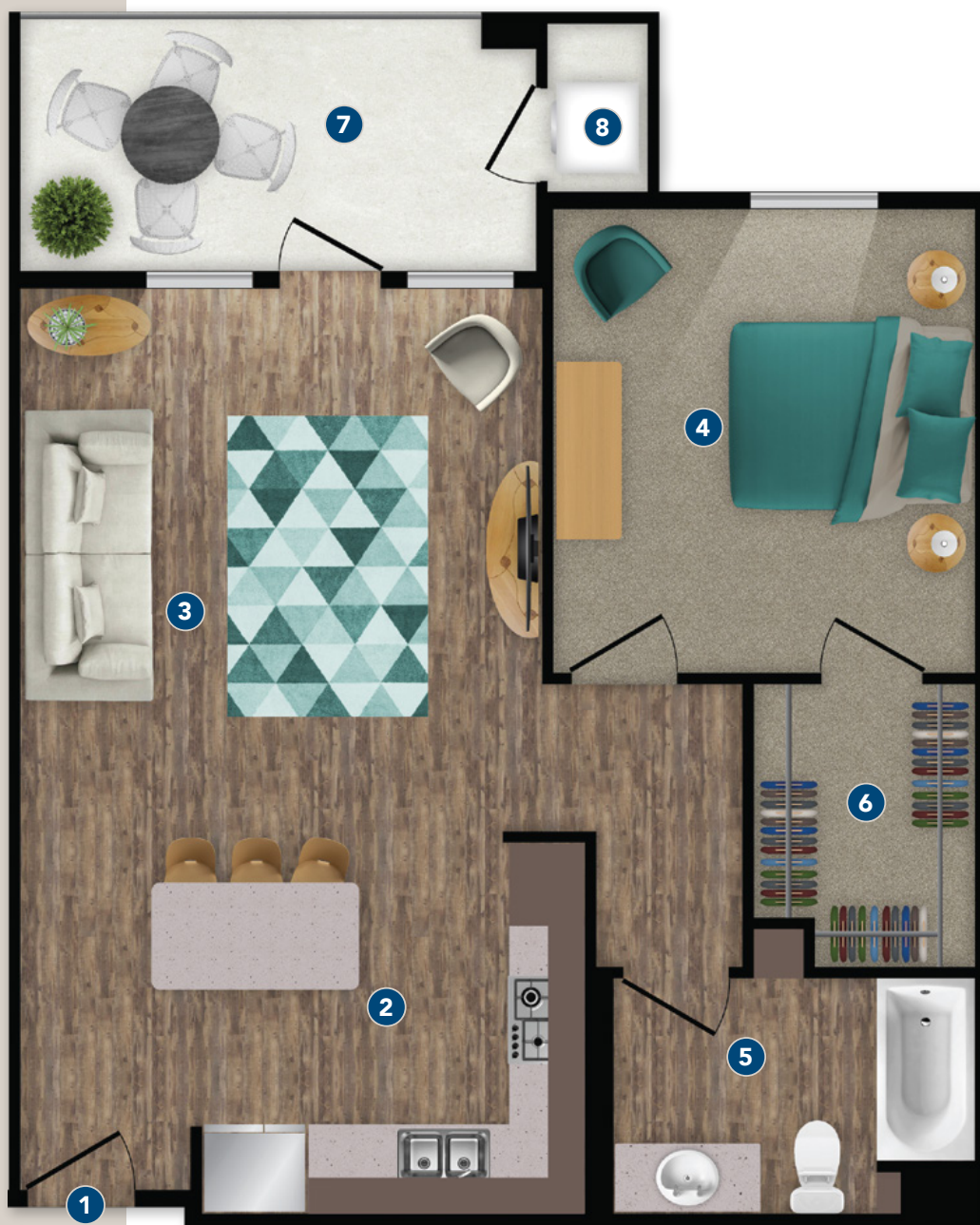

* Floor area approximate dimensions only

1. Wood inspired flooring throughout 1st floor apartments
2. Carpeted bedrooms only in level 2-4 apartments
3. Some 4th floor balconies may not be covered

NOTE: This apartment plan and its furnishings/fixings are representational only. This should only be viewed as a general guide to the layout and relationship of rooms/spaces within the apartment plan.

Not to be interpreted as accurate scale drawings.